

Product description

MAIN FEATURES

MINIATURE, UP TO 4 POSITIONS

- › PCB mounting (THT, reflow version on request)
- › Switching torque: Up to 3.5 Ncm
- › Gold plated contacts
- › Washable (sealed contact system)
- › IP68 front panel sealing
- › Operating temperature range: -40 to +85 °C
- › Various options and customizations

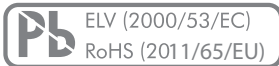

PRODUCT VARIETY

- Vertical or horizontal mounting
- Shorting or non-shorting
- Switching torque 2.2 or 3.5 Ncm
- Front panel sealing IP60 or IP68
- Number of positions
- Bushing style
- Shaft style and length

TYPICAL APPLICATIONS

- Industrial controls
- Avionics, test and measurement systems
- Medical and audio equipment
- Mobile equipment
- Transport and constructions machines

07R

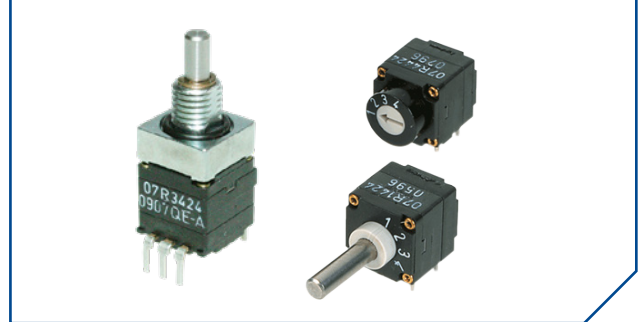

POSSIBLE CUSTOMIZATIONS

- Shaft dimension and shape
- Bushing dimension
- Switching torque
- Others

Dimensions and pin assignment

SWITCH DESIGN AND PIN ASSIGNMENT

HORIZONTAL, WITH SHAFT, WITHOUT THREADED BUSHING

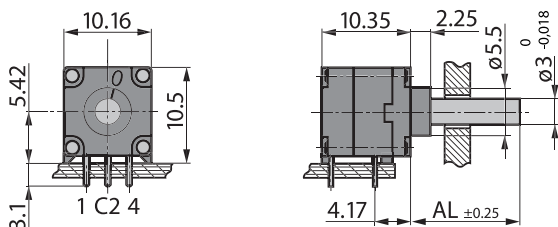

HORIZONTAL, SCREWDRIVER WITH BEZEL

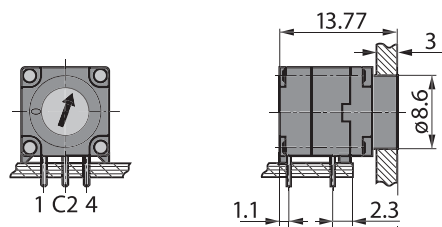

HORIZONTAL, WITH SHAFT, WITH THREADED BUSHING

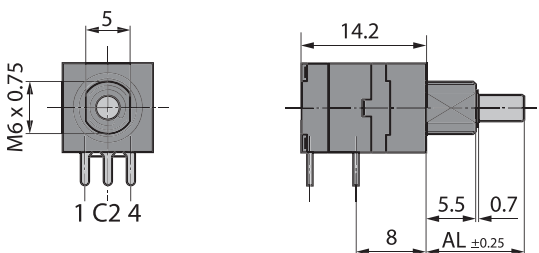

HORIZONTAL, WITH SHAFT, WITHOUT THREADED BUSHING

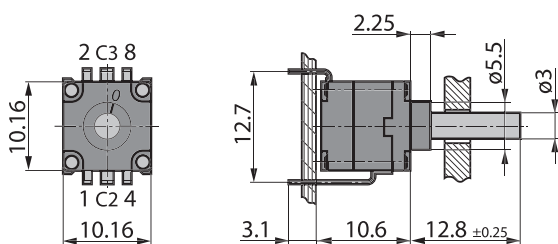

VERTICAL, SCREWDRIVER WITHOUT BEZEL

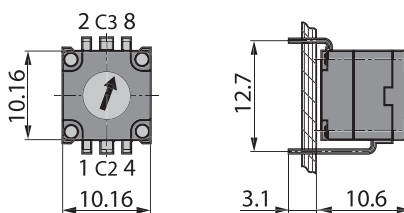

VERTICAL, WITH SHAFT, WITH THREADED BUSHING

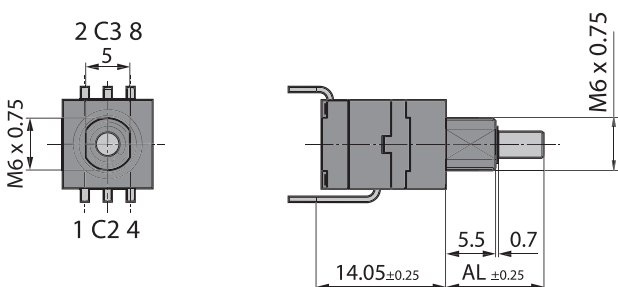

Dimensions in mm
Tolerances according to DIN ISO 2768-1 (m), unless otherwise specified

Dimensions and pin assignment

DRILLING DIAGRAM AND FOOTPRINT

HORIZONTAL, WITH SHAFT,
WITHOUT THREADED BUSHING

View from component side of the PCB

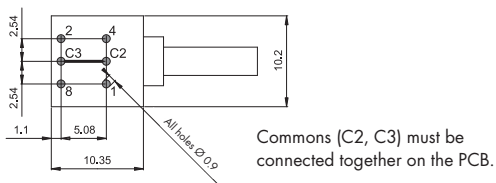

HORIZONTAL, WITH SHAFT,
WITH THREADED BUSHING

View from component side of the PCB

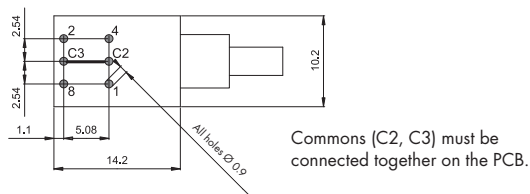

VERTICAL, WITH SHAFT,
WITHOUT THREADED BUSHING

View from component side of the PCB

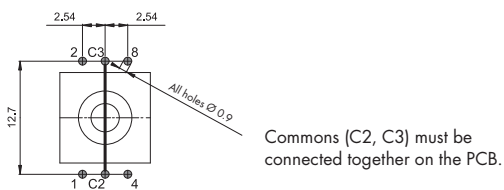

VERTICAL, WITH SHAFT,
WITH THREADED BUSHING

View from component side of the PCB

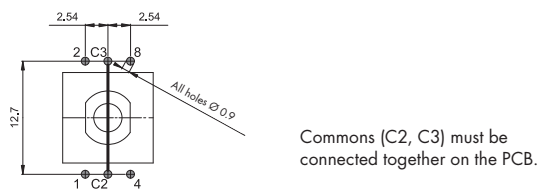

FRONT PANEL CUT OUT

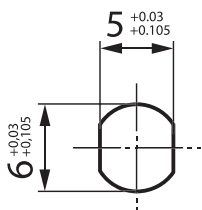

NUT

HEX NUT (SUPPLIED)

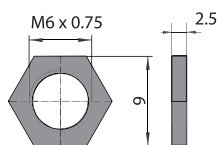

SLOTTED NUT

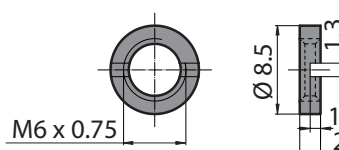

Dimensions in mm
Tolerances according to DIN ISO 2768-1 (m), unless otherwise specified

Output signal

PIN TO POSITION DIAGRAM

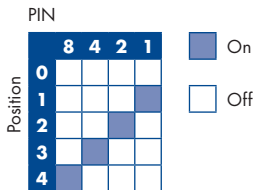

Ordering information

ORDERING CODE

07R	-	-	-	-	-	-	-	-	-
-----	---	---	---	---	---	---	---	---	---

TYPE

- 0** Horizontal | screwdriver without bezel
- 1** Horizontal | with shaft
- 2** Vertical | screwdriver without bezel
- 3** Vertical | with shaft
- 4** Horizontal | screwdriver with bezel
- 5** Vertical | screwdriver with bezel

NUMBER OF POSITIONS AND CONTACTS

- 2** 2 positions (1 - 2)
- 3** 3 positions (1 - 3)
- 4** 4 positions (1 - 4)
- 5** 5 positions (0 - 4, 0 has no connection)

1 TO 4 | 5 POSITIONS

- 1** 5 positions (factory set for 5 positions)
- 2** 1 to 4 positions (factory set for 2, 3 and 4 positions)

SWITCHING MODE

- 3** Shorting
- 4** Non-shorting

SHAFT LENGTH (AL)

- 000** Basic style: 12.8 mm
Threaded bushing: 11.5 mm
- xxx**¹ Customized
(shaft length rounded to next 0.5 mm,
e.g. 10.3 mm = 10.5 mm or 10 mm)

¹ Customized shaft length (AL)
AL measured from mounting face (see picture below)

Max. shaft length (AL):
Bushing basic style = 30 mm
Bushing threaded = 26 mm

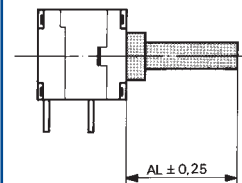

BUSHING | IP-SEALING

- 00** None
- 20** Threaded (nut supplied)
- 30** Threaded | IP68 (nut supplied)

SWITCHING TORQUE | PACKAGING

- 2.2 Ncm | tray (50 / 200 pieces)
- V** 2.2 Ncm | antistatic tray (100 pieces)
- T** 3.5 Ncm | tray (50 / 200 pieces)
- S** 3.5 Ncm | antistatic tray (100 pieces)

Ordering information

STANDARD TYPES¹

HORIZONTAL

With shaft, without threaded bushing

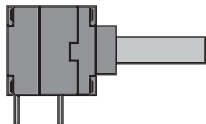

SWITCHING MODE	FUNCTION (POLES X POSITIONS)	PART NUMBER
Shorting	1 x 4	07R1423
Non-shorting	1 x 4	07R1424
Shorting	1 x 5 (4 electrical positions)	07R1513
Non-shorting	1 x 5 (4 electrical positions)	07R1514

Screwdriver with bezel | front panel operation

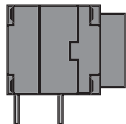

SWITCHING MODE	FUNCTION (POLES X POSITIONS)	PART NUMBER
Shorting	1 x 4	07R4423
Non-shorting	1 x 4	07R4424
Shorting	1 x 5 (4 electrical positions)	07R4513
Non-shorting	1 x 5 (4 electrical positions)	07R4514

With shaft, with threaded bushing, IP68

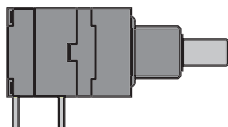

SWITCHING MODE	FUNCTION (POLES X POSITIONS)	PART NUMBER
Shorting	1 x 4	07R1423-30000
Non-shorting	1 x 4	07R1424-30000
Shorting	1 x 5 (4 electrical positions)	07R1513-30000
Non-shorting	1 x 5 (4 electrical positions)	07R1514-30000

¹ For other types | options see ordering code

Ordering information

STANDARD TYPES¹

VERTICAL

With shaft, without threaded bushing

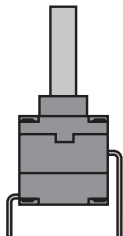

SWITCHING MODE	FUNCTION (POLES X POSITIONS)	PART NUMBER
Shorting	1 x 4	07R3423
Non-shorting	1 x 4	07R3424
Shorting	1 x 5 (4 electrical positions)	07R3513
Non-shorting	1 x 5 (4 electrical positions)	07R3514

Screwdriver with bezel | front panel operation

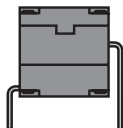

SWITCHING MODE	FUNCTION (POLES X POSITIONS)	PART NUMBER
Shorting	1 x 4	07R2423
Non-shorting	1 x 4	07R2424
Shorting	1 x 5 (4 electrical positions)	07R2513
Non-shorting	1 x 5 (4 electrical positions)	07R2514

With shaft, with threaded bushing, IP68

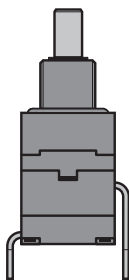

SWITCHING MODE	FUNCTION (POLES X POSITIONS)	PART NUMBER
Shorting	1 x 4	07R3423-30000
Non-shorting	1 x 4	07R3424-30000
Shorting	1 x 5 (4 electrical positions)	07R3513-30000
Non-shorting	1 x 5 (4 electrical positions)	07R3514-30000

PACKAGING

Foam polystyrene box:

50 or 200 pieces (depending on shipment quantity)

ACCESSORIES AND SPARE PARTS

Hex nut M6 x 0.75:

Part number 4424-22 (50 pieces / bag), brass

Slotted nut M6 x 0.75:

Part number 4424-28 (50 pieces / bag), brass

Part number 4424-31 (50 pieces / bag), stainless steel (cross slot)

¹ For other types | options see ordering code

Specifications

MECHANICAL DATA

Detent angle positions:	36° detent angle 5 positions
Rotary limitation end stop:	Configurable
Switching torque:	2.2 or 3.5 Ncm ($\pm 25\%$ in new condition)
Rotational life:	> 10'000 cycles (tested at room temperature)
Rotational stop strength:	> 45 Ncm
Fastening torque of nut (front panel mounting):	M6 x 0.75: < 100 Ncm

ELECTRICAL DATA

Electrical connection:	Pins 0.4 x 0.7 mm
Switching voltage:	< 42 VDC (resistive load)
Switching current:	< 2'000 mA (resistive load)
Contact resistance:	< 50 m Ω (in new condition)
Switching function:	1 pole, 2 to 5 positions
Switching mode:	Shorting or non-shorting
Dielectric strength:	500 VDC during 60 s (pin-to-pin, pin-to-housing)
Insulation resistance:	> 1 G Ω at 500 VDC (pin-to-pin, pin-to-housing, in new condition)

MATERIALS

Shaft:	Stainless steel 1.4305
Bushing housing:	Zinc die casting, fiberglass reinforced high performance plastic
Contact surface:	Cu alloy (Au plated)
Soldering leads:	Cu alloy (tin plated)
Hex nut:	Brass
Slotted nut:	Brass or stainless steel
O-rings:	NBR (nitrile rubber), 70 shore A

ENVIRONMENTAL DATA

Operating temperature:	-40 to +85 °C (IEC 60068-2-14)
Storage temperature:	-40 to +85 °C (IEC 60068-2-14)
IP sealing against front panel:	IP60 without sealing IP68 with shaft and front panel sealing (2 bar, 1 h)
Vibration:	10 G _{RMS} at 10 to 2'000 Hz
Flammability:	UL94-HB

SOLDERING CONDITIONS

Hand soldering:	< 280 °C during 2 s
Wave soldering:	< 280 °C during 2 s

©Copyright 2018 by Elma Electronic AG, CH-8620 Wetzikon. Subject to technical modifications, all data supplied without liability.

Please contact our sales team for more details.

China: +86 21 5866 5908
France: +33 388 56 72 50

Germany: +49 7231 97 34 0
Israel: +972 3 930 50 25

Singapore: +65 6479 8552
Switzerland: +41 44 933 41 11

United Kingdom: +44 1234 838 822
United States: +1 510 656 3400