

THIS DOCUMENT IS THE PROPERTY OF
KEYSTONE ELECTRONICS CORP. AND
SHALL NOT BE REPRODUCED, DISTRIBUTED
OR USED AS A BASIS FOR MANUFACTURE
WITHOUT PRIOR WRITTEN PERMISSION
FROM KEYSTONE ELECTRONICS CORP.

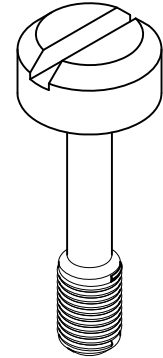
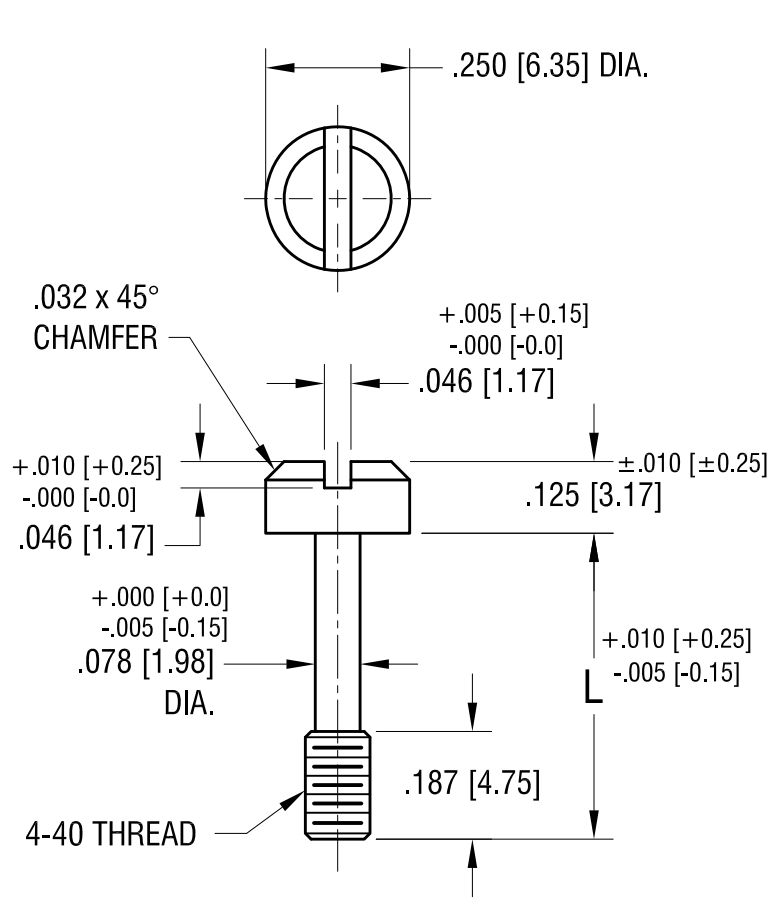

| PART NO. | 'L' DIM. |
|----------|--------------|
| 2413 | .469 [11.91] |
| 2414 | .531 [13.49] |

| DATE | DESCRIPTION | REV. |
|----------|--------------------------|------|
| 12.17.10 | CHANGE AS PER ECN 10-089 | C |
| 7.15.08 | CHANGE AS PER ECN 08-123 | B |
| 3.27.08 | CHANGE AS PER ECN 08-098 | A |

| KEYSTONE ELECTRONICS CORP. | | | |
|----------------------------|-----------------|-----------------|-----------|
| ASTORIA, N.Y. 11105-2017 | | | |
| PART NAME | | CAPTIVE SCREW | |
| MATERIAL | | STAINLESS STEEL | |
| FINISH | - | DRN BY | BOONE |
| | | APP'D | LN |
| | | DATE | 12.5.95 |
| | | SCALE | 3X |
| TOLERANCES | INCH [MM] | CODE | DWG NO. |
| DECIMAL | ± .005 [± 0.15] | C/M | 2413-2414 |
| ANGULAR | ± 1° | | |
| UNLESS OTHERWISE SPECIFIED | | | |