



SERIES 0100 - SINGLE-POLE TOGGLE SWITCHES

TO 2 A 250 V AC



PRODUCT FEATURES

- Robust and powerful toggle switch with 50 000 mechanical switching cycles
- Central fastening with nut M12
- Metal or plastic lever

ON REQUEST

- Other terminal variants

Mechanical life endurance	5E4
Material actuator housing terminals	metal / PA (product-dependent) CuZn nickel-plated / Duroplast (base) / chromated galvanized steel (bracket plate) silver plated

single-pole	Actuator color / printing	Housing color	2 A 250 V 1E3	Terminal type	Contact distance (mm)	Contact material	Miscellaneous	Stock version
ON / OFF switch (SPST)								
0100.1201					≥ 3	CuZn silver plated	actuating torque 45,0 ±14,0 Nmm	
0100.2901					≥ 3	CuZn silver plated	actuating torque 45,0 ±14,0 Nmm metal lever	

ROCKER SWITCHES

PUSHBUTTON SWITCHES

TOGGLE SWITCHES

SLIDE SWITCHES

ROTARY SWITCHES

FOOT SWITCHES

TACT AND KEY SWITCHES

SNAP-ACTION SWITCHES

MICRO-SIGNAL SWITCHES

SENSORS

ECO

PUSH-TO-ON



TOGGLE SWITCHES

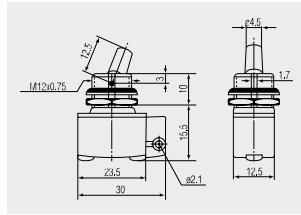

Basic type 0100



Aluminum identification plate to
plugging on and with black inscription
"ON" and "OFF"

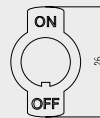

Identification plate made of CuZn nickel-plated for plugging on and with twist protection and stamped inscription "ON" and "OFF"